

COUNCIL AGENDA: FEBRUARY 17, 2015

SUBJECT: AUTHORIZATION TO ADVERTISE FOR BIDS – LIME STREET AND LAUREL AVENUE SEWER AND WATER PROJECT

SOURCE: Public Works Department - Engineering Division

COMMENT: Plans and Project Manual have been prepared for the Lime Street and Laurel Avenue Sewer and Water Project. The project consists of installing new master plan sewer main, water main, sewer laterals, and the removal of the existing water and sewer infrastructure. The project will be located on Lime Street between Mulberry Avenue and Laurel Avenue, and on Laurel Avenue between Lime Street and Second Street.

The portion of work on Lime Street will include water and sewer utilities. The work on Laurel Avenue will only include sewer. This project is a precursor to the reconstruction of Lime Street. Due to the highly expansive soil along this stretch of road, the proposed street section will be deeper than usual. The age of the existing pipe material could be in danger of failing during construction and therefore, staff believes it is prudent to remove and replace the aging infrastructure prior to the reconstruction of the road.

The Plans and Project Manual have been completed and are available in the Pete V. McCracken Conference Room for Council's review. The Estimate of Probable Cost for the project is \$591,600 with \$59,160 required for the construction contingency (10%). It is anticipated an additional \$47,328 is required for construction management, construction surveying, quality control and inspection services (8%) for a total estimated cost of \$698,088.

In the past, contractors awarded a City project would have hired their own land surveyors. Due to a recent ruling by the State of California Board of Professional Engineers, Land Surveyors and Geologists, staff must directly engage the services of a land surveyor. The Board of Professional Engineers, et al, has ruled that a contractor is in violation of Business and Professional Code sections 8726 and 8729 if he (contractor) hires the land surveyor.

Partial funding for the project is approved in the 2014/2015 budget. Funding in the amount of \$350,000 will come from the Sewer Revolving Fund. Funding in the amount of \$125,000 will come from the Water Replacement Fund as shown in the 2014/2015 Annual Budget.

Dir BSA Appropriated/Funded ME

CM

J

Item No. 4

There is currently a \$223,088 shortfall to fully construct the project. The project needs an additional \$110,941 from the Water Replacement Fund and \$112,147 from the Sewer Revolving Fund. Staff respectfully requests that the City Council appropriate \$110,941 from the Water Replacement Fund and \$112,147 from the Sewer Revolving Fund. Funding for the appropriations is available.

RECOMMENDATION: That City Council:

1. Approve staff's recommended plans and project manual;
2. Authorize staff to advertise for bids on the project;
3. Authorize the City Engineer to negotiate construction surveying services with one of the firms as approved by Council MO #02-100714; and
4. Authorize the Finance Director to appropriate \$110,941 from the Water Replacement Fund and \$112,147 from the Sewer Revolving Fund to fully fund this project.

ATTACHMENTS: Engineer's Cost Estimate  
Locator Map

**Lime Street and Laurel Avenue Water and Sewer Project**  
**on Lime between Mulberry to Laurel and on Laurel from Lime to Second**

City of Porterville

ITEM NO.	DESCRIPTION	UNIT	QUANTITY	UNIT PRICE	TOTAL PRICE
1	Mobilization and Clean Up	LS	1	\$ 20,000.00	\$ 20,000.00
2	Sheeting and Shoring	LS	1	\$ 10,000.00	\$ 10,000.00
3	Traffic Control	LS	1	\$ 10,000.00	\$ 10,000.00
4	Furnish Utility Locating	LS	1	\$ 15,000.00	\$ 15,000.00
5	15" PVC Sewer SDR 35	LF	1330	\$ 65.00	\$ 86,450.00
6	18" PVC Sewer SDR35	LF	980	\$ 75.00	\$ 73,500.00
7	Install 48" Sewer Manhole	EA	4	\$ 5,000.00	\$ 20,000.00
8	Install 48" Sewer Manhole and provide 6" PVC Sewer Stub and provide proper connection to existing sewer	EA	3	\$ 6,000.00	\$ 18,000.00
9	Install 48" Sewer Manhole and provide 8" PVC Sewer Stub and provide proper connection to existing sewer	EA	1	\$ 7,000.00	\$ 7,000.00
10	Install 48" Sewer Manhole on existing 27" sewer line and provide proper connection to proposed 18 Pipe	EA	1	\$ 7,000.00	\$ 7,000.00
11	Install 4" Sewer laterals	EA	13	\$ 1,500.00	\$ 19,500.00
12	Connect to Existing Sewer Manhole and Install new manhole Bottom	EA	1	\$ 7,000.00	\$ 7,000.00
13	Install 8" PVC C900 Pipe DR18	LF	1300	\$ 50.00	\$ 65,000.00
14	Install 8" Gate Valves	EA	3	\$ 3,000.00	\$ 9,000.00
15	Install 8"x6" Tee	EA	3	\$ 2,000.00	\$ 6,000.00
16	Install tapping sleeve and valve onto existing 8" line	EA	1	\$ 8,000.00	\$ 8,000.00
17	Install tapping sleeve and valve onto existing 16" line	EA	1	\$ 10,000.00	\$ 10,000.00
18	Reconnect existing water Services to new line	EA	18	\$ 1,000.00	\$ 18,000.00
19	Re-route 16" Water per Detail shown	LS	1	\$ 10,000.00	\$ 10,000.00
20	Re-route 8" Water per Detail shown	LS	1	\$ 8,000.00	\$ 8,000.00
21	Furnish AC sawcutting and removal	LS	1	\$ 10,000.00	\$ 10,000.00
22	Trench Patch 3" over 6" Base for Sewer Main	LF	2310	\$ 30.00	\$ 69,300.00
23	Trench Patch 3" over 6" Base for Water Main	LF	980	\$ 25.00	\$ 24,500.00
24	Trench Patch for Sewer Laterals	LF	310	\$ 25.00	\$ 7,750.00
25	Trench Patch for Water Services	LS	1	\$ 5,000.00	\$ 5,000.00
26	Remove Existing 8" Water Main and provide backfill	LF	1295	\$ 10.00	\$ 12,950.00
27	Remove Existing 6" Sewer Main and Manholes and provide backfill	LF	2310	\$ 15.00	\$ 34,650.00
Sub Total					\$ 591,600.00
10% Contingency					\$ 59,160.00
<b>Total</b>					<b>\$ 650,760.00</b>

 2-6-15  
Project Manager Date

 2/10/15  
Public Works Director Date

 2/10/2015  
City Engineer Date

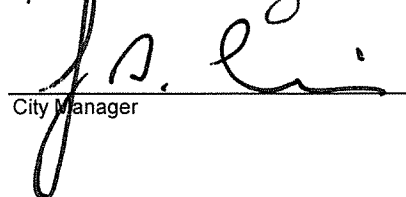
 02/11/15  
City Manager Date



SCALE = N.T.S.

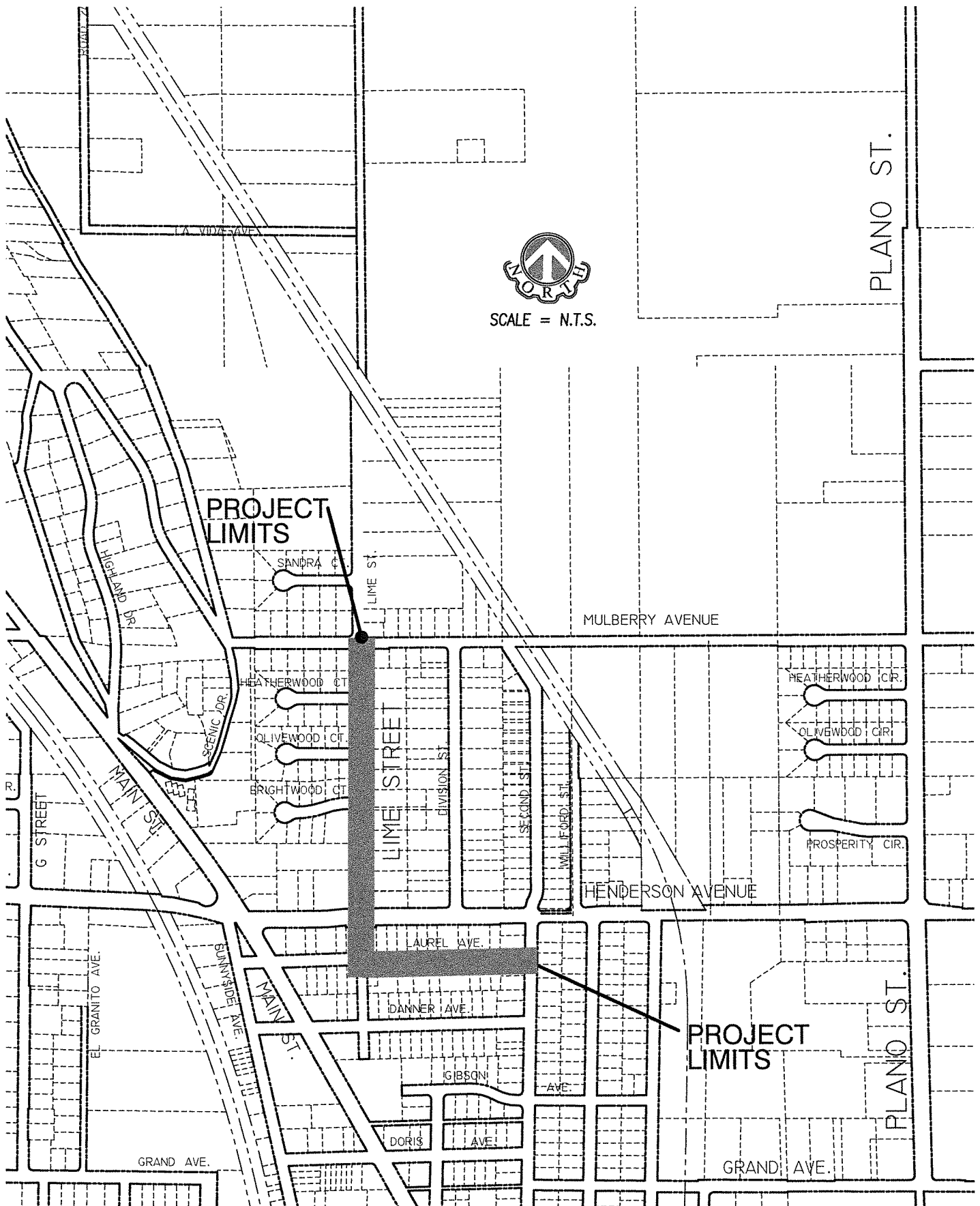

CITY OF PORTERVILLE  
ENGINEERING DIVISION

291 NORTH MAIN STREET  
PORTERVILLE, CA. 93257  
(559) 782-7462

LIME AND LAUREL  
SEWER AND WATER  
PROJECT

OWNER	-
APN	-
AREA	-
ACRES	-
SCALE	N.T.S.
DATE	-
DRAWN BY	-
CHECKED BY	-